

P.C.B LAYOUT

REVISION DATA		
REV	DESCRIPTION	DATE
A0	NEW DRAWING	2018-04-02

### Specification

Material:  
 Contact Material: Brass  
 Contact plating: Au or Sn Over30-50u" Ni  
 Insulator Material: Black Polyester UL94V-0  
 Standard: PA6T/PA9T/LCP + 30%G.F

Electrical:  
 Current rating: 1.0Amps/contact max.  
 Contact resistance: ≤ 20mΩ/contact  
 Insulation resistance: ≥ 500MΩ at V=100V  
 Withstanding Voltage: 300V AC/minute

Mechanical:  
 Operating temperature: -40°C to +105°C  
 Wave soldering temperature: 255 ± 5°C, 10s

PROJECT	PA (mm)	H (mm)	PC (mm)
Standard	2.00	1.00	2.0
Specified			

PB01	1XX1	D	XX	X	B	X	X	DXXX
Product Descriptions PB01 H1.0 W1.3	No. of Positions 02-50P	Angle Type D Straight	Contact Plated SN Tin120u" MT 锡120u" GF Gold 0.8u" G1 Au1u" G3 Au3u" G4 Au5u" G6 Au10u" G7 Au15u" G8 Au30u" GA Au1.5u" S1 半金锡1u"	Insulator Material C PA6T E PA9T F LCP	Insulator Color B Black	Insulator Feature N Without Peg	Packing Options A PE Bag C PVC Box D Tube	Series No. DXXX L=PA+H+PC

**GSAMTEK® 东莞市广溯电子科技有限公司**  
 DONGGUAN GUANG SU ELECTRONIC TECHNOLOGY CO.,LTD

TOLERANCE	PROJECTON		TITLE:
ANGLE ±5°	DATE :	2018-04-02	单排180度排针 PH1.0 H1.0 W1.3 系列图
X.XXX ±0.10	DRAWN :	SAMTEK	PART NO. PB011X1DXXXBXXDXXX
X.XX ±0.20	CHECKED :		DRAWING NO.
X.X ±0.30	APPROVED :		REV: A0 UNIT: mm SCALE: 3:1 SIZE: A4
X. ±0.50			

4 3 2 1

REVISION DATA		
REV	DESCRIPTION	DATE
A0	NEW DRAWING	2018-04-02

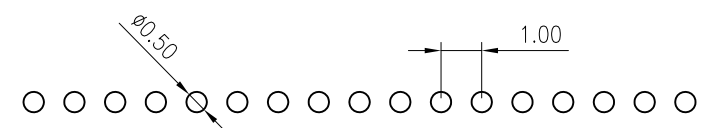
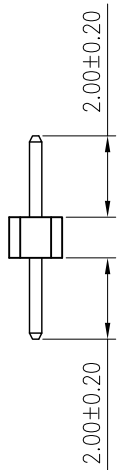
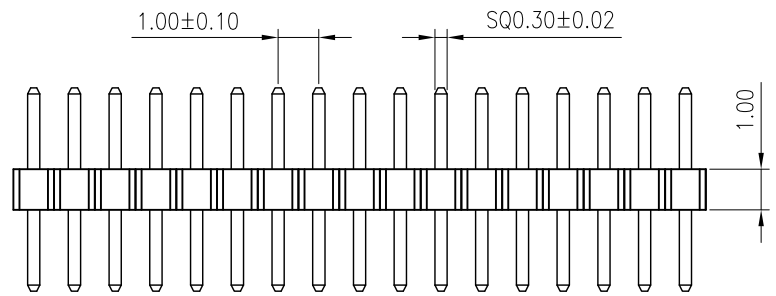
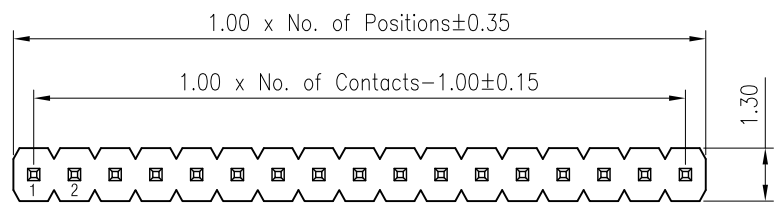

P.C.B LAYOUT

## Specification

Material:  
 Contact Material: Brass  
 Contact plating: Au or Sn Over 30-50u" Ni  
 Insulator Material: Black Polyester UL94V-0  
 Standard: PA6T/PA9T/LCP + 30%G.F

Electrical:  
 Current rating: 1.0Amps/contact max.  
 Contact resistance: ≤ 20mΩ/contact  
 Insulation resistance: ≥ 500MΩ at V=100V  
 Withstanding Voltage: 300V AC/minute

Mechanical:  
 Operating temperature: -40°C to +105°C  
 Wave soldering temperature: 255 ± 5°C, 10s

PB01	1XX1	D	XX	X	B	X	X	D001
Product Descriptions PB01 H1.0 W1.3	No. of Positions 02-50P	Angle Type D Straight	Contact Plated SN Tin120u" MT 锡120u" GF Gold 0.8u" G1 Au1u" G3 Au3u" G4 Au5u" G6 Au10u" G7 Au15u" G8 Au30u" GA Au1.5u" S1 半金锡1u"	Insulator Material C PA6T E PA9T F LCP	Insulator Color B Black	Insulator Feature N Without Peg	Packing Options A PE Bag C PVC Box D Tube	Series No. D001 L5.0mm PA2.0 PC2.0

## GSAMTEK® 东莞市广溯电子科技有限公司 DONGGUAN GUANG SU ELECTRONIC TECHNOLOGY CO.,LTD

TOLERANCE ANGLE ±5° X.XXX ±0.10 X.XX ±0.20 X.X ±0.30 X. ±0.50	PROJECTON		TITLE: 单排180度排针 PH1.0 H1.0 W1.3 L5.0 PA2.0 PC2.0
	DATE :	2018-04-02	PART NO. PB011XX1DXXXBXD001
	DRAWN :	SAMTEK	DRAWING NO.
	CHECKED :		REV: A0
	APPROVED :		UNIT: mm
		SCALE: 3:1	SIZE: A4

4 3 2 1