

4

3

2

1

## REVISION DATA

| REV | DESCRIPTION | DATE       |
|-----|-------------|------------|
| A0  | NEW DRAWING | 2017-05-02 |

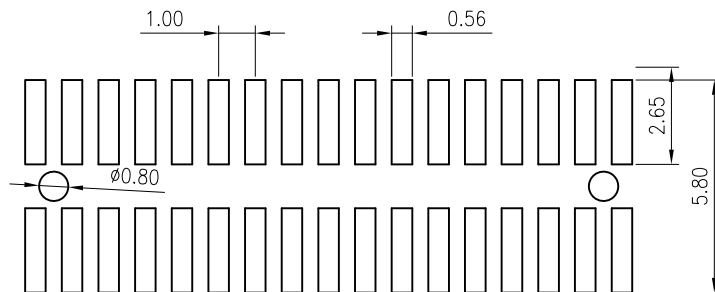
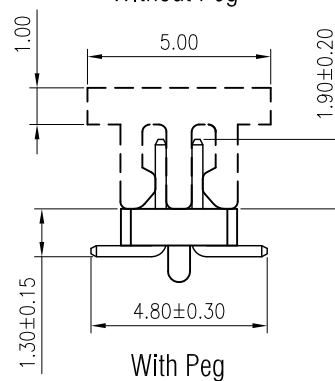
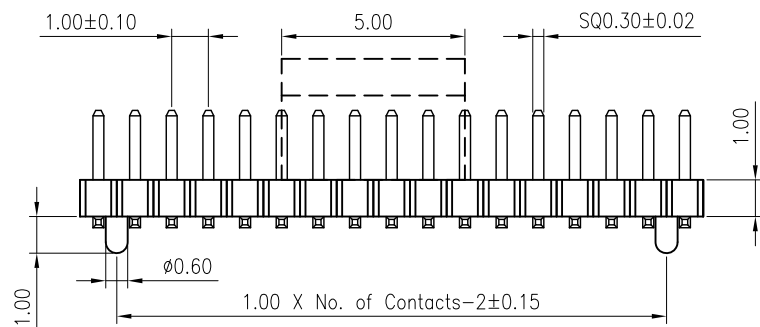
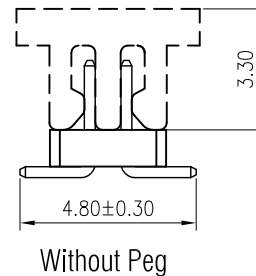
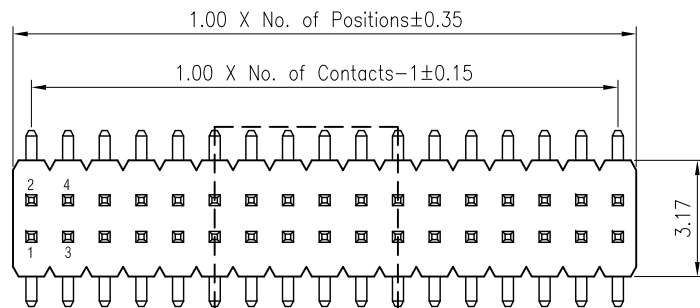

P.C.B LAYOUT

## Specification

## Material:

Contact Material: Brass

Contact plating: Au or Sn Over 30-50  $\mu$  Ni

Insulator Material: Black Polyester UL94V-0

Standard: PA6T/PA9T/LCP + 30%G.F

## Electrical:

Current rating: 1.0Amps/contact max.

Contact resistance:  $\leq 20\text{m}\Omega$ /contactInsulation resistance:  $\geq 500\text{M}\Omega$  at V=100V

Withstanding Voltage: 300V AC/minute

## Mechanical:

Operating temperature:  $-40^\circ\text{C}$  to  $+105^\circ\text{C}$ Reflow soldering temperature:  $260 \pm 5^\circ\text{C}$ , 10s

P02

12

XXX

XX

S

X

B

X

X

S001

|  |                             |                             |   |                          |   |                            |  |   |  |
|--|-----------------------------|-----------------------------|---|--------------------------|---|----------------------------|--|---|--|
| Product Descriptions<br>P02 H1.0 W3.17 | Product Type<br>12 Dual Row | No. of Positions<br>04-100P | Contact Plated<br>SN Tin120 $\mu$<br>MT 锡120 $\mu$<br>GF Gold 0.8 $\mu$<br>G1 Au1 $\mu$<br>G3 Au3 $\mu$<br>G4 Au5 $\mu$<br>G6 Au10 $\mu$<br>G7 Au15 $\mu$<br>G8 Au30 $\mu$<br>GA Au1.5 $\mu$<br>S1 半金锡1 $\mu$ | Angle Type<br>S SMT Type | Insulator Material<br>C PA6T<br>E PA9T<br>F LCP | Insulator Color<br>B Black | Insulator Feature<br>N Without Peg<br>W With Peg | Packing Options<br>C PVC Box<br>D Tube<br>E Tube+CAP<br>F Tape Reel<br>G Reel+CAP | Series No.<br>S001 L4.80mm<br>PA1.9 PB0<br>PW4.8 |
|--|-----------------------------|-----------------------------|---|--------------------------|---|----------------------------|--|---|--|

**GSAMTEK® 东莞市广溯电子科技有限公司**  
 DONGGUAN GUANG SU ELECTRONIC TECHNOLOGY CO.,LTD

| TOLERANCE           | PROJECTON  |            | TITLE:                                       |
|---------------------|------------|------------|--|
| ANGLE $\pm 5^\circ$ | DATE :     | 2017-05-02 | 双排SMT排针 PH1.0 H1.0 W3.17 L4.8 PA1.8 PB PW4.8 |
| X.XXX $\pm 0.10$    | DRAWN :    | SAMTEK     | PART NO. P0212XXXXXXBXSS001                  |
| X.XX $\pm 0.20$     | CHECKED :  |            | DRAWING NO.                                  |
| X.X $\pm 0.30$      | APPROVED : |            | REV: A0 UNIT: mm SCALE: 5:1 SIZE: A4         |
| X. $\pm 0.50$       |            |            |  |

4

3

2

1