

4 3 2 1

REVISION DATA		
REV	DESCRIPTION	DATE
A0	NEW DRAWING	2015-09-17

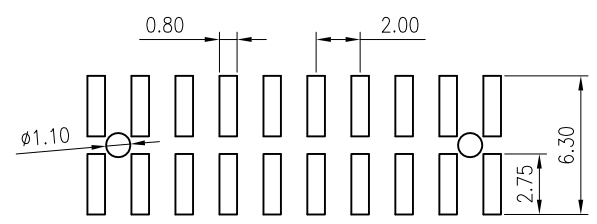
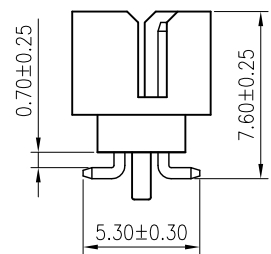
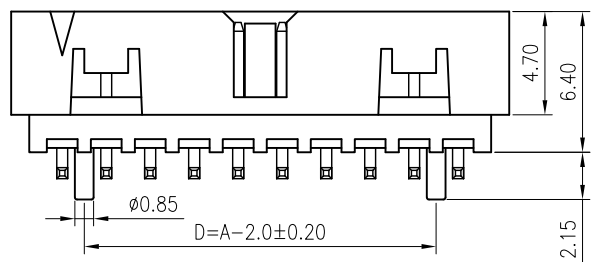
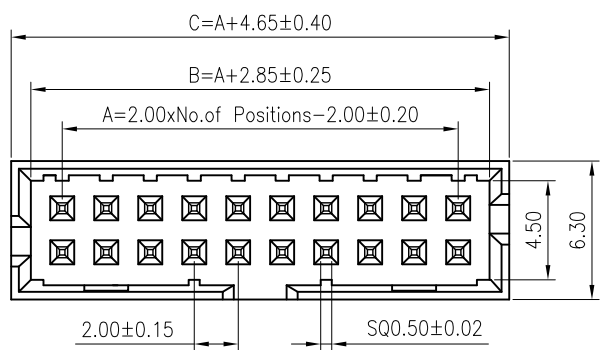

P.C.B LAYOUT

Specification

Material:
 Contact Material: Brass
 Contact plating: Au or Sn Over30-50µ" Ni
 Insulator Material: Black Polyester UL94V-0
 Standard: PA6T/PA9T/LCP + 30%G.F

Electrical:
 Current rating: 2.0Amps/contact max.
 Contact resistance: ≤20mΩ/contact
 Insulation resistance: ≥1000MΩ at V=100V
 Withstanding Voltage: 500V AC/minute

Mechanical:
 Operating temperature: -40°C to +105°C
 Reflow soldering temperature: 260±5°C,10s

B05	12	XXX	XX	S	X	B	W	X	S001
Product Descriptions B05 PH2.0 H6.4	Product Type 12 Dual Row	No.of Positions 04-50P	Contact Plated SN Tin120µ" MT 锡120µ" GF Gold 0.8µ" G1 Au1µ" G3 Au3µ" G4 Au5µ" G6 Au10µ" G7 Au15µ" G8 Au30µ" GA Au1.5µ" S1 半金锡1µ"	Angle Type S SMT Type	Insulator Material C PA6T E PA9T F LCP	Insulator Color B Black	Insulator Feature W With Peg	Packing Options A PE Bag B Tray C PVC Box D Tube	Series No. S001 L8.25mm PB0.7 PW5.3

GSAMTEK® 东莞市广溯电子科技有限公司
 DONGGUAN GUANG SU ELECTRONIC TECHNOLOGY CO.,LTD

TOLERANCE	PROJECTON		TITLE:
ANGLE ±5°	DATE :	2015-09-17	双排SMT带内柱筒牛 PH2.0 H6.4 L8.25 PB0.7 PW5.3
X.XXX ±0.10	DRAWN :	SAMTEK	PART NO. B0512XXXXXSBWXS001
X.XX ±0.20	CHECKED :		DRAWING NO.
X.X ±0.30	APPROVED :		REV: A0 UNIT: mm SCALE: 3:1 SIZE: A4
X. ±0.50			

4 3 2 1